

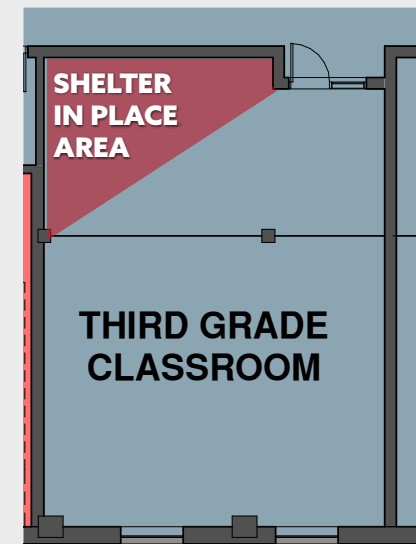

A FUTURE FOR KENNEDY ELEMENTARY A PROPOSED CENTRALIZED PreK-5 ELEMENTARY

REVEAL. REFLECT.
VISUALIZE THE FUTURE.

GROUND FLOOR PROJECT HIGHLIGHTS



SAFETY FIRST

After meeting with teachers, and parents as part of the Student Safety Advisory Committee along with gathering the hundreds of responses to date on the MAPS 2020 Vision, Safety, is a top priority. That is why **shelter in place areas** are created in ALL K-5 classrooms. These areas are equipped to be safe sight line areas for teachers and students to retreat to in the event of an in-building emergency.



Each grade wing is partitioned off by controlled doors that can be activated in the central office in the event of an emergency. These doors will close, sealing the classroom wings from the circulation areas of the building, providing an additional level of safety to students in the building. These are located on each floor, entering each classroom wing.

GROUP SPACES

FOR CLASS COLLABORATION & JOINT LEARNING AREAS

Centrally located group areas, where classrooms and teachers and jointly educate and create group exercises are available in the heart of the second and third grade classroom wing. This will allow teachers more flexibility than just the areas inside of their classrooms. In addition, the lower lockers in this area allow sight lines by teachers to keep a better eye on students when in the group area.



LOCKERS & GROUP SPACE



SECOND GRADE CLASSROOM



SECOND GRADE STORAGE WALL

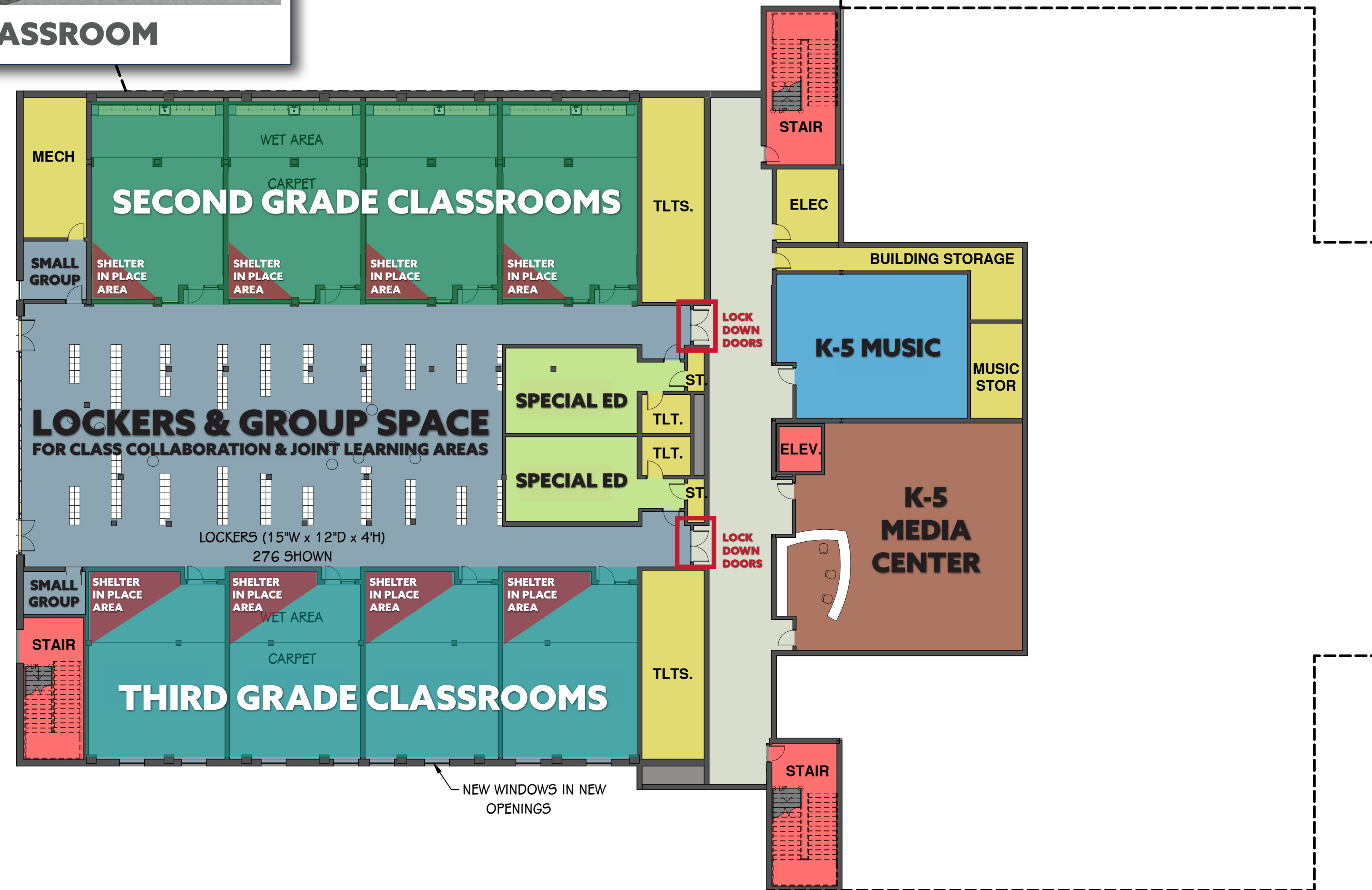
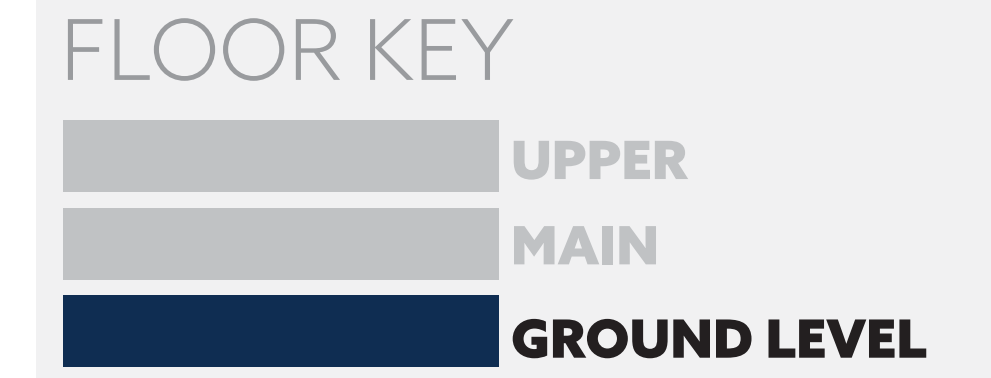

PROPOSED GROUND FLOOR ELEMENTARY PLAN

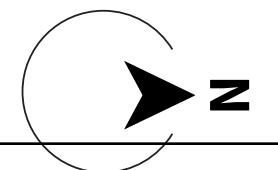

6TH STREET

MAPLE STREET